

# CAVITY WALL

Cavity widths from 50mm-165mm

<b>OUTER LEAF</b>	<b>INNER LEAF</b>
<b>102mm</b>	<b>100mm</b>

## S/K

Blockwork built tight against inner face of the lintel. Place mortar bed on top of blockwork before floor units are laid to provide even distribution of load. Lintels may be propped to facilitate speed of construction. See Lintel Installation on page 6.



## Standard Load

### S/K-90 (For cavity widths 90-105mm)

Manufactured length 150mm increments	600- 1200	1350- 1500	1650- 1800	1950- 2100	2250- 2400	2550- 2700	2850- 3000	3150- 3600	3750- 4000	4200- 4800
Height 'h'	88	85	107	125	150	162	171	200	200	200
Thickness	1.6	2.0	2.0	2.0	2.0	2.6	2.6	3.2	3.2	3.4
Total UDL kN 3:1	12	16	19	21	23	27	27	27	26	27
Total UDL kN 19:1	10	13	16	17	18	22	20	20	19	22

### 90-105mm Cavity

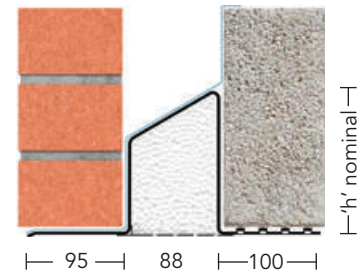

### S/K-110 (For cavity widths 110-125mm)

Manufactured length 150mm increments	600- 1500	1650- 1800	1950- 2100	2250- 2700	2850- 3000	3150- 4000	4200- 4800
Height 'h'	97	113	125	163	193	193	218
Thickness	2.0	2.0	2.0	2.5	2.9	3.2	3.2
Total UDL kN 3:1	16	22	21	25	27	26	25
Total UDL kN 19:1	13	18	17	20	22	19	20

### 110-125mm Cavity

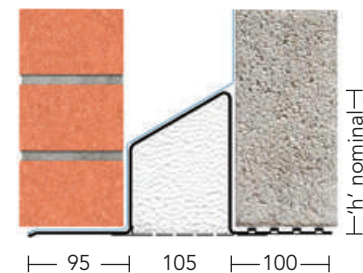

### S/K-150 (For cavity widths 150-165mm)

Manufactured length 150mm increments	600- 1500	1650- 1800	1950- 2100	2250- 2700	2850- 3000	3150- 4000	4200- 4800
Height 'h'	100	118	130	148	173	173	199
Thickness	2.0	2.0	2.0	2.5	2.9	3.2	3.2
Total UDL kN 3:1	16	22	21	25	27	26	25
Total UDL kN 19:1	13	18	17	20	22	19	20

### 150-165mm Cavity

